

24(W)xK7-SFC / RCN.23-1

# NRHD 24 C / 24(W)xK7

## Rotation resistant compacted hoist rope

**NRHD 24 C / 24(W)xK7** is a rotation resistant, compacted hoisting rope for a broad spectrum of uses including tower cranes, mobile cranes, crawler cranes, high lift hoisting devices and deck cargo cranes.

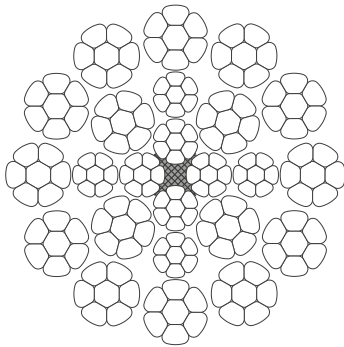

NRHD 24 C / 24(W)xK7 / 2018/v1.0

Diameter		Section	Mass	Minimum breaking load
mm	inch	mm <sup>2</sup>	kg/m	kN 1960 MPa
8	5/16	34.4	0.31	56
9	-	43.6	0.39	71
10	-	53.8	0.48	88
11	7/16	65.1	0.58	107.4
12	-	77.5	0.69	127
12.5	-	84.1	0.75	138
13	1/2	91.0	0.81	147
14	9/16	106.0	0.94	175
15	-	121.1	1.07	197
16	5/8	137.8	1.22	224
18	-	174.4	1.54	283
19	3/4	194.3	1.72	315
20	-	215.3	1.91	350
21	-	237.3	2.10	385
22	7/8	260.5	2.31	423
			<b>f - Fill Factor</b>	<b>k - Spinning Loss Factor</b>
			0.685	0.832

**Please note:** Other diameters with other tolerances than those shown here can be made on studies.

Indicative values - Tolerance on diameter: ArcelorMittal design (0; +4%)

### Features:

- Higher breaking load than NRHD 24 with same diameter
- Excellent behaviour for multilayer coiling winches thanks to long lay and strands compaction
- Bright or galvanised steel wires 1960 N/mm<sup>2</sup>
- Optional plastic impregnation of the interface between outer strands and core improving the rope behaviour in case of heavy duty applications (load, fleet angles, repetitive lifting cycles).

**PLEASE NOTE:** NRHD 24 C is available with plastic impregnation which improves the rope behaviour in case of fleet angles and repetitive lifting cycles, and is recommended for high rise heavy duty and intensive use. Average minimum breaking load is 2% lower.



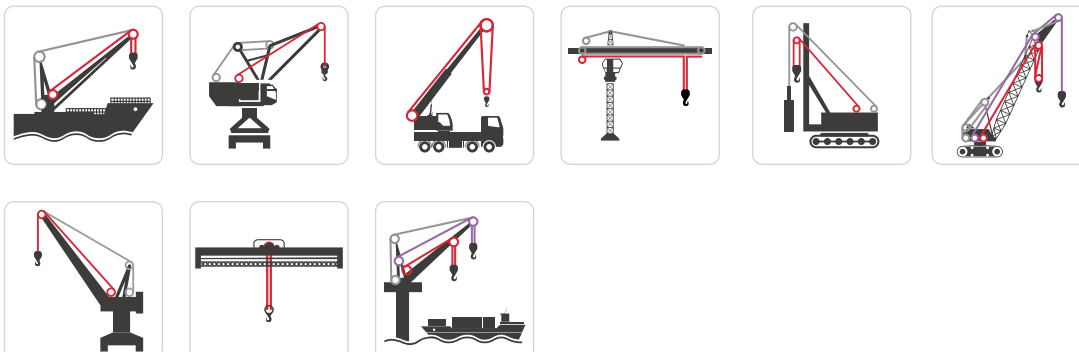

## Applications



### KEY

- Hoist
- Trolley
- Boom Luffing
- Grab
- Auxiliary Hoist
- Pipe Handling

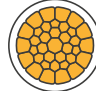
## NRHD 24 C wire rope properties

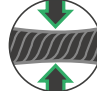
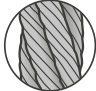
 <p><b>Lubrication</b></p>	 <p><b>Bending Fatigue Resistance</b></p>	 <p><b>Compaction</b></p>	 <p><b>Rotation Resistance</b></p>	 <p><b>High Breaking Resistance</b></p>	 <p><b>Resistance to Crushing</b></p>	 <p><b>Lang Lay Rope</b></p>
<p>Extends the life and increases rope performance.</p>	<p>Ropes designed to cope with bending repeatedly under stress.</p>	<p>Smoother outer surface with increased strength and reduced wear.</p>	<p>Resistance to spin and rotation whilst under load.</p>	<p>Ropes featuring a high breaking force.</p>	<p>Ropes designed to withstand or resist external forces.</p>	<p>Increased wear resistance and flexibility.</p>

## Storage and maintenance

The rope must be adequately maintained and regularly lubricated, as often as it is necessary, but at least when the rope works in extreme conditions and before/after prolonged inactivity. The lubricant must be compatible with the original grease. Before re-lubrication, the wire rope must be dry and cleaned by scraping. Cleaning by cloth, cryogenic spray, high pressure cleaner and solvents are forbidden.

When stored, the rope should be kept in a dry and ventilated environment with no direct contact with the floor and an air flow under the reel. Visual inspection is necessary before the use of a stored wire rope. In case of doubt of the quality of the wire rope, we can help you to find and make additional inspection analysis.

## EWRIS handling recommendations

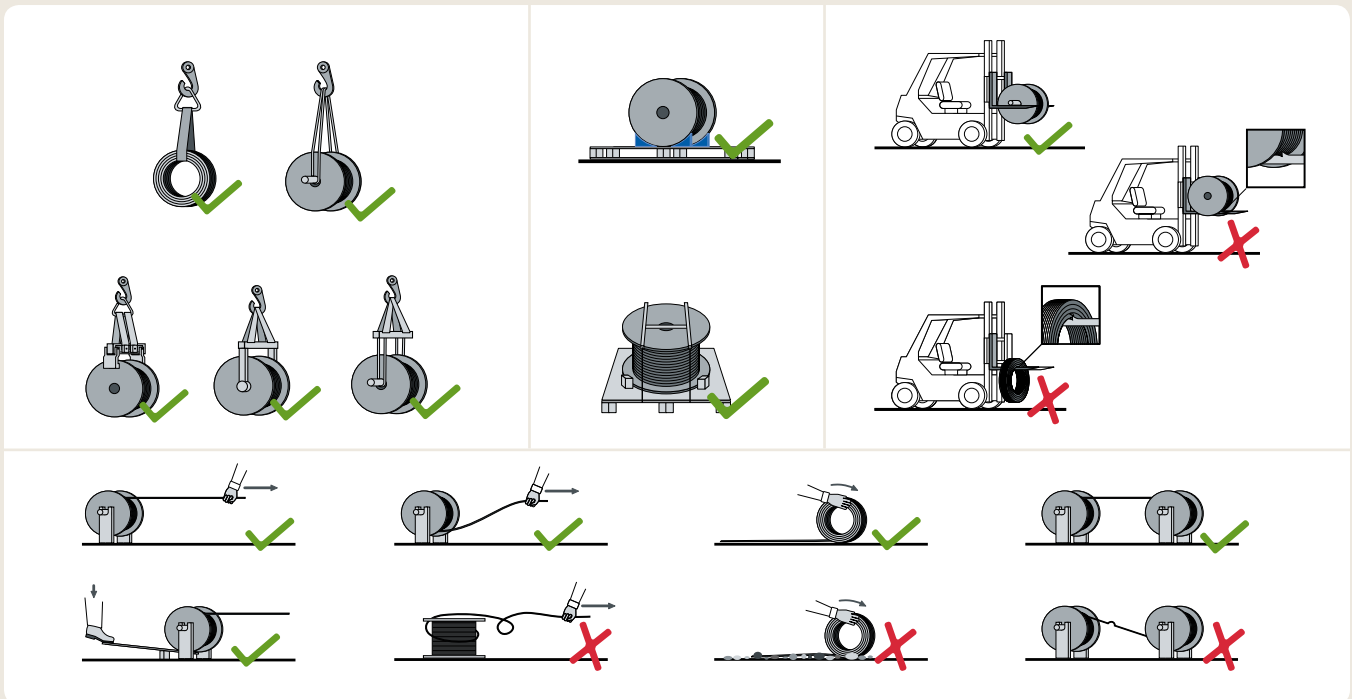

At all times, contact of the rope with any metallic pieces should be avoided to prevent early damage.



All information in this promotional material shall illustrate products and services in a non final way and invite to further technical or commercial explanation; they are not contractual. © ArcelorMittal 2018.

High performance **Hoisting Ropes**  
for the most demanding environments

ArcelorMittal ROPES, 25 Avenue de Lyon, BP 38, F-01002 Bourg-en-Bresse Cedex  
Telephone: +33 4 74 32 82 12 | Fax: +33 4 74 32 81 05 | Email: [lifting.ropes@arcelormittal.com](mailto:lifting.ropes@arcelormittal.com)  
[www.arcelormittal.com/wireropes](http://www.arcelormittal.com/wireropes)

**ArcelorMittal ROPES**  
ENGINEERING EXCELLENCE